



Hutton Road, Shenfield

Deceptively spacious two double bedroom first floor maisonette, centrally located in Shenfield and just 0.3 miles from the mainline station which gives access to central London within 26 minutes. Features include; generous lounge/diner, separate kitchen with appliances, bathroom and a separate WC. The property has double glazed windows and electric energy efficient heaters. Available immediately, unfurnished. EPC D. Please note, no parking is included with this property.

£1,500.00 pcm

Council Tax Band B

01277 225191
lettings@wnproperties.co.uk



Ground Floor Entrance Hall

First Floor Landing

Lounge/Diner
11' 10" x 14' 9" (3.60m x 4.49m)

Kitchen
10' 10" x 8' 4" (3.30m x 2.54m)

Bedroom One
9' 6" x 14' 9" (2.89m x 4.49m)

Bedroom Two
13' 1" x 13' 9" (3.98m x 4.19m)

Bathroom
5' 5" x 10' 2" (1.65m x 3.10m)

Guest WC

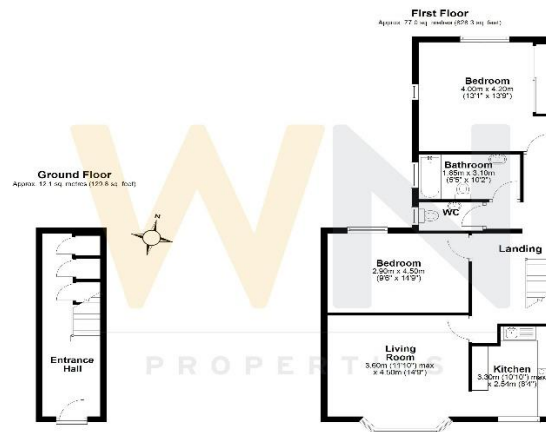

HOLDING DEPOSIT

A one week holding deposit is required to secure this property. Please ask for a copy of our 'Guide for Tenants' for a full list of costs applicable to this or any of our properties. Please note your holding deposit is at risk if you withdraw from the transaction or do not disclose something that affects your ability to pass references.